

A/C Mounting Bracket

空调安装支架



Standard A series Bracket

- * Galvanized steel; weatherproof polyester powder coating
- * Anti-vibration rubber pads
- * Pull down design makes installation fast and easy

Model	Description	Thickness	Max Loading
A-150	365 x 450 mm	1.7 mm	150 kg
A-180	365 x 450 mm	2.0 mm	180 kg
A-200	400 x 500 mm	2.0 mm	200 kg
A-250	500 x 550 mm	2.0 mm	250 kg



Standard C series Bracket

- * Galvanized steel; weatherproof polyester powder coating
- * Anti-vibration rubber pads

Model	Description	Thickness	Max Loading
C-180	460 x 460 mm	1.8 mm	180 kg
C-200	500 x 500 mm	2.0 mm	200 kg
C-250	550 x 550 mm	2.0 mm	250 kg
C-300	600 x 600 mm	2.0 mm	300 kg



Crossbar B series Bracket

- * Galvanized steel; weatherproof polyester powder coating
- * Anti-vibration rubber pads
- * Pull down design makes installation fast and easy

Model	Description	Thickness	Max Loading
B-180	450 x 350 x 700 mm	1.8 mm	180 kg
B-250	550 x 450 x 850 mm	2.0 mm	250 kg



Roof-mount R series Bracket

- * Galvanized steel; weatherproof polyester powder coating
- * Anti-vibration rubber pads
- * To suit roof pitch from 3 to 45 degrees

Model	Description	Thickness	Max Loading
R-180	800 x 585 mm	1.5 mm	180 kg

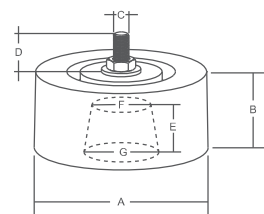
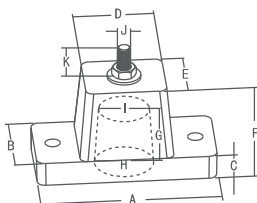

Model	Dimensions										
	A	B	C	D	E	F	G	H	I	J	K
A-01	107	48	15	48	38	58	36	35	30	8	20
A-02	112	50	17	53	43	60	40	36	30	8	20
A-03	110	48	17	50	38	90	90	35	26	8	20

Model	Dimensions						
	A	B	C	D	E	F	G
B-01	87	42	8	20	24	48	66
B-02	97	60	10	30	33	50	60